

1 PANEL SHAKER MOLDED DOORS

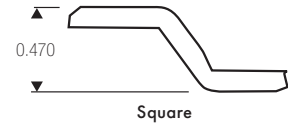

SMOOTH

6'8" SQUARE



HOLLOW CORE DOOR

- 1-3/8" and 1-3/4" hollow core
- Fiberwood or Fingerjoint stiles and rails

SOLID CORE DOOR

- 1-3/8" and 1-3/4" solid core
- Gives solid feel with sound reduction
- Fingerjoint stiles and rails

Sizes Available

Dimensions	Availability	Panels
1'0" x 6'8"	X	1
1'2" x 6'8"	X	1
1'3" x 6'8"	X	1
1'4" x 6'8"	X	1
1'6" x 6'8"	X	1
1'8" x 6'8"	X	1
1'10" x 6'8"	√	1
2'0" x 6'8"	√	1
2'2" x 6'8"	X	1
2'4" x 6'8"	√	1
2'6" x 6'8"	√	1
2'8" x 6'8"	√	1
2'10" x 6'8"	X	1
3'0" x 6'8"	√	1

NOTE: Items designated with an X are cut from larger size skins.
Items designated with a √ are available for order. NA for Not Available.

1 PANEL SHAKER MOLDED DOORS

SMOOTH 6'8" SQUARE



Standard Dimensions

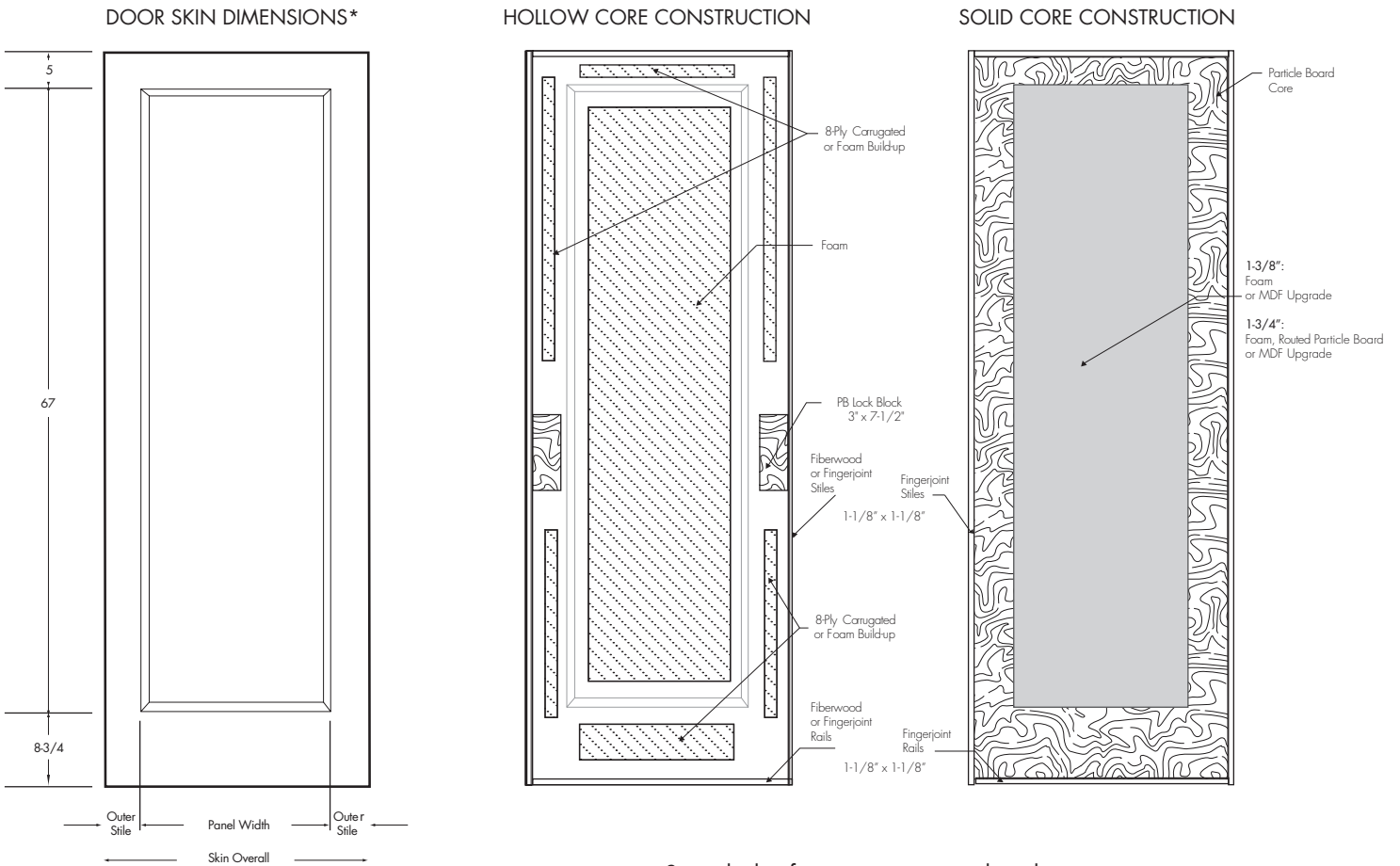

*Measurements are approximate and before any required trim or adjustments for customer specifications

Smooth skin faces are paint grade only.
All measurements are approximate.
All door facings are nominal 1/8" thick.
Type 2 glue bond standard.

Skin Size	Skin Overall	Panel Width	Center Stile	Outer Stile
1'0" x 6'8"	1'0-3/8"	5-3/8"	NA	3-1/2"
1'2" x 6'8"	1'2-3/8"	5-3/8"	NA	4-1/2"
1'3" x 6'8"	1'3-3/8"	5-3/8"	NA	5"
1'4" x 6'8"	1'4-3/8"	7-7/8"	NA	4-1/4"
1'6" x 6'8"	1'6-3/8"	7-7/8"	NA	5-1/4"
1'8" x 6'8"	1'8-3/8"	11-1/2"	NA	4-7/16"
1'10" x 6'8"	1'10-3/8"	11-1/2"	NA	5-7/16"

Skin Size	Skin Overall	Panel Width	Center Stile	Outer Stile
2'0" x 6'8"	2'0-3/8"	1'3-1/2"	NA	4-7/16"
2'2" x 6'8"	2'2-3/8"	1'3-1/2"	NA	5-7/16"
2'4" x 6'8"	2'4-3/8"	1'6-1/2"	NA	4-15/16"
2'6" x 6'8"	2'6-3/8"	1'8-1/2"	NA	4-15/16"
2'8" x 6'8"	2'8-3/8"	1'10-1/2"	NA	4-15/16"
2'10" x 6'8"	2'10-3/8"	1'10-1/2"	NA	5-15/16"
3'0" x 6'8"	3'0-3/8"	2'2-1/2"	NA	4-15/16"

Note: A standard 2-1/8" bore diameter will require a minimum stile measurement of 3-11/16" to allow for a 2-3/8" backset. A standard 2-1/8" bore diameter will require a minimum stile measurement of 4-1/16" to allow for a 2-3/4" backset.