

2 PANEL SQUARETOP MOLDED DOORS

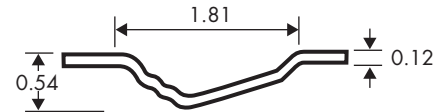

SMOOTH

7'0" BEAD AND COVE - ADA DESIGN



Bead and Cove profile

HOLLOW CORE DOOR

- 1-3/8" and 1-3/4" hollow core
- Fingerjoint or Fiberwood stiles
- Wood rails available

SOLID CORE DOOR

- 1-3/8" and 1-3/4" solid core
- Gives solid feel with sound reduction
- All wood construction
- Available in particle board core

Sizes Available

Dimensions	Availability	Panels
2'10" x 7'0"	√	2
3'0" x 7'0"	√	2

NOTE: Items designated with an X are cut from larger size skins.
Items designated with a √ are available for order. NA for Not Available.

2 PANEL SQUARETOP MOLDED DOORS

SMOOTH 7'0" B/C - ADA DESIGN



Standard Dimensions

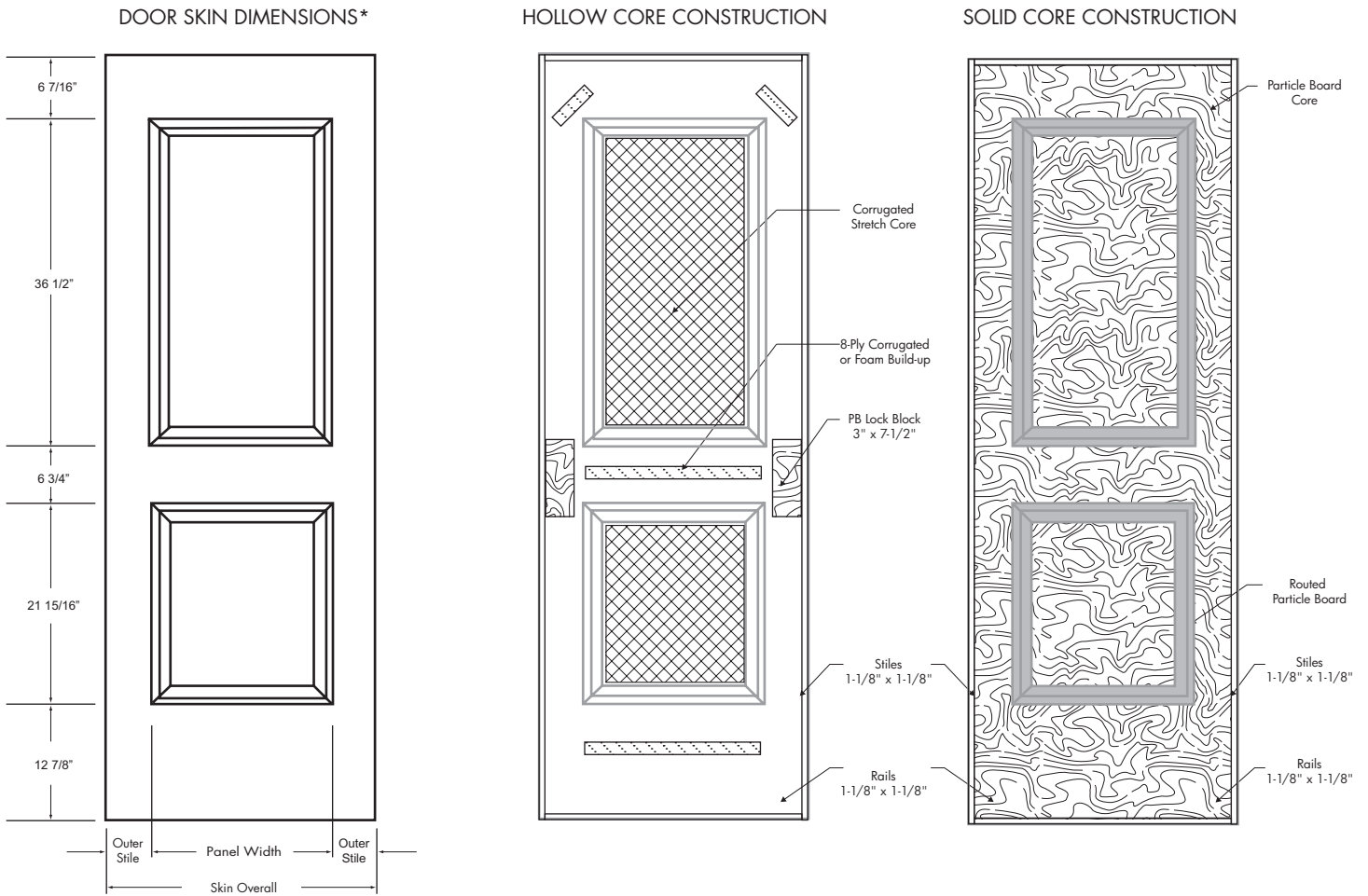

*Measurements are approximate and before any required trim or adjustments for customer specifications

Smooth skin faces are paint grade only.
All measurements are approximate.
All door facings are nominal 1/8" thick.
Type 2 glue bond standard.

Skin Size	Skin Overall	Panel Width	Center Stile	Outer Stile
2'10" x 7'0"	2'10-1/2"	1'11-9/16"	NA	5-1/2"
3'0" x 7'0"	3'0-1/2"	1'11-9/16"	NA	6-1/2"

Note: A standard 2-1/8" bore diameter will require a minimum stile measurement of 3-11/16" to allow for a 2-3/8" backset. A standard 2-1/8" bore diameter will require a minimum stile measurement of 4-1/16" to allow for a 2-3/4" backset.